



Yes, you can:

Tel: 01656 776222  
 Email: ordersuk@invacare.com  
 www.invacare.co.uk

Matrx MAC Back  
 October 2024

<b>Account Name :</b>	<b>Account No :</b>
<b>Address :</b>	<b>Order No :</b>
<b>Tel No:</b>	<b>Order Qty :</b>
<b>Delivery address :</b>	<b>Order Date :</b>

**Matrx MAC Multi-Adjustable Contour (New)**  
 Retail Order form  
 Maximum User Weight: 136kg

- Features:**
- Ergonomically shaped contour back shell
  - Scapular Support for tilt and recline applications
  - Choice of 3 depth of Trunk Supports
  - Trunk Supports height and width adjustable
  - Optional HUG StaminaFibre® Insert OR Dual Layer Foam
  - 40° angle adjustment
  - 10cm depth adjustment
  - Headrest Interface
  - All backs include Easyset Hardware
  - Hardware Alignment Tool



Height	Width					
	Inch	16	17	18	19	20
	cm	41	43	46	48	51
	FITS W/C	15-18"	16-19"	17-20"	18-21"	19-22"
16	41	E	E	E	E	E
18	46	E	E	E	E	E
20	51	E	E	E	E	E
22	56	E	E	E	E	E

**EasySet Hardware**



Soft, conformable StaminaFibre® for maximum immersion and envelopment

Code	X	Description	Price		
<b>MAC Back with- HUG StaminaFibre® Insert</b>					
		<b>Dimension in cm (width/height) Hardware included</b>	<b>Fits wheelchair widths: 2" wider or 1" narrower</b>		
		<b>Description in brackets refers to MatrX MAC code</b>	<b>Inches</b>	<b>cm</b>	
1634678		MAC Adj fit W 41/43cm (MACHUG4141) HUG StaminaFibre®	16	41	£575.00
1634679		MAC Adj fit W 41/43cm (MACHUG4146) HUG StaminaFibre®	16	41	£575.00
1634680		MAC Adj fit W 41/43cm (MACHUG4151) HUG StaminaFibre®	16	41	£575.00
1634681		MAC Adj fit W 41/43cm (MACHUG4156) HUG StaminaFibre®	16	41	£575.00
1634682		MAC Adj fit W 43/46cm (MACHUG4341) HUG StaminaFibre®	17	43	£575.00
1634683		MAC Adj fit W 43/46cm (MACHUG4346) HUG StaminaFibre®	17	43	£575.00
1634684		MAC Adj fit W 43/46cm (MACHUG4351) HUG StaminaFibre®	17	43	£575.00
1634685		MAC Adj fit W 43/46cm (MACHUG4356) HUG StaminaFibre®	17	43	£575.00
1634686		MAC Adj fit W 46/48cm (MACHUG4641) HUG StaminaFibre®	18	45	£575.00
1634687		MAC Adj fit W 46/48cm (MACHUG4646) HUG StaminaFibre®	18	45	£575.00
1634688		MAC Adj fit W 46/48cm (MACHUG4651) HUG StaminaFibre®	18	45	£575.00
1634689		MAC Adj fit W 46/48cm (MACHUG4656) HUG StaminaFibre®	18	45	£575.00
1634690		MAC Adj fit W 48/51cm (MACHUG4841) HUG StaminaFibre®	19	48	£575.00
1634691		MAC Adj fit W 48/51cm (MACHUG4846) HUG StaminaFibre®	19	48	£575.00
1634692		MAC Adj fit W 48/51cm (MACHUG4851) HUG StaminaFibre®	19	48	£575.00
1634693		MAC Adj fit W 48/51cm (MACHUG4856) HUG StaminaFibre®	19	48	£575.00
1634694		MAC Adj fit W 51/53cm (MACHUG5141) HUG StaminaFibre®	20	51	£575.00
1634695		MAC Adj fit W 51/53cm (MACHUG5146) HUG StaminaFibre®	20	51	£575.00
1634696		MAC Adj fit W 51/53cm (MACHUG5151) HUG StaminaFibre®	20	51	£575.00
1634697		MAC Adj fit W 51/53cm (MACHUG5156) HUG StaminaFibre®	20	51	£575.00

MAC Back with Dual Foam Layer Insert				
1634609	MAC Adj fit W 41/43cm (MAC4146) Dual Layer Foam	16	41	£332.50
1634610	MAC Adj fit W 41/43cm (MAC4151) Dual Layer Foam	16	41	£332.50
1634611	MAC Adj fit W 41/43cm (MAC4156) Dual Layer Foam	16	41	£332.50
1634612	MAC Adj fit W 43/46cm (MAC4341) Dual Layer Foam	17	43	£332.50
1634613	MAC Adj fit W 43/46cm (MAC4346) Dual Layer Foam	17	43	£332.50
1634614	MAC Adj fit W 43/46cm (MAC4351) Dual Layer Foam	17	43	£332.50
1634615	MAC Adj fit W 43/46cm (MAC4356) Dual Layer Foam	17	43	£332.50
1634616	MAC Adj fit W 46/48cm (MAC4641) Dual Layer Foam	18	45	£332.50
1634617	MAC Adj fit W 46/48cm (MAC4646) Dual Layer Foam	18	45	£332.50
1634618	MAC Adj fit W 46/48cm (MAC4651) Dual Layer Foam	18	45	£332.50
1634619	MAC Adj fit W 46/48cm (MAC4656) Dual Layer Foam	18	45	£332.50
1634620	MAC Adj fit W 48/51cm (MAC4841) Dual Layer Foam	19	48	£332.50
1634621	MAC Adj fit W 48/51cm (MAC4846) Dual Layer Foam	19	48	£332.50
1634622	MAC Adj fit W 48/51cm (MAC4851) Dual Layer Foam	19	48	£332.50
1634623	MAC Adj fit W 48/51cm (MAC4856) Dual Layer Foam	19	48	£332.50
1634624	MAC Adj fit W 51/53cm (MAC5141) Dual Layer Foam	20	51	£332.50
1634625	MAC Adj fit W 51/53cm (MAC5146) Dual Layer Foam	20	51	£332.50
1634626	MAC Adj fit W 51/53cm (MAC5151) Dual Layer Foam	20	51	£332.50
1634627	MAC Adj fit W 51/53cm (MAC5156) Dual Layer Foam	20	51	£332.50

#### Additional Hardware



1545277	Fixed Space Saver Mounting Hardware FSSH			£140.00
1545278	Split Mounting hardware SMH			£127.40
	Extended Range Hardware			#N/A

#### Trunk Supports \* must be selected one left and right unless using asymmetrical contour. Please specify Qty 1 or 2 against size required



1634628	9cm Contour Depth (MLCS)			£70.00
1634629	15cm Contour Depth (MLCD)			£70.00
1634630	23cm Contour Depth (MLCXD)			£70.00

#### Laterals



#### Fixed laterals

1632755	Easy fix laterals for Elite E2 backs 6.5" H, 5" Deep (Pair) can be fixed on inside or outside of back shell			£111.30
1545167	Standard Left Lateral (191mm long x 127mm high) PBL-S-L			£91.70
1545168	Standard Right Lateral (191mm long x 127mm high) PBL-S-R			£91.70
1545172	Small Left Lateral (140mm long x 76mm high) PBSS-L			£91.70
1545225	Small Left Lateral (140mm long x 76mm high) PBSS-R			£91.70
1545169	Offset Left Lateral (For 76mm height adjustment ) PBOL-L			£91.70
1545170	Offset Right Lateral (For 76mm height adjustment) PBOL-R			£98.70

Swing away laterals				
1551913		Swing Away Hardware for Left or Right Side SAHEB	Swings completely behind back. Does not interfere with flip-back arms	£98.70
1544798		Offset Left Swing Away Hardware (Each) OSAH-L	Allows 76mm higher or lower pad position relative to attachment slot	£98.70
1544799		Offset Right Swing Away Hardware (Each) OSAH-R	Allows 76mm higher or lower pad position relative to attachment slot	£98.70
1544292		Extra Small Lateral Pad 82.5mm x 108mm (Each) EPAD-XS		£60.20
1544291		Small Lateral Pad 89mm x 133mm (Each) EPAD-S		£60.20

**Shape Insert**

1634816	 <p>Shape Insert Customizable shape interface for accommodation of orthopedic asymmetries. Designed to be cut to the desired shape/size without fraying. Can be configured/adjusted as necessary to meet the needs of the end user.</p>	Extended Range Mounting Hardware upgrade recommended when using Shape Insert	£230.00
---------	--	--	---------

**PSIS support**

1632759	E2 Backbone PSIS support	£50.00
---------	--------------------------	--------

**Posture Flex**



1632760	PostureFlex Abdom Supp H:6.5in,Lgth 16 to 23in PFLEX-M	£117.60
1632761	PostureFlex Abdom Supp H:7in,Lgth 20 to 32in PFLEX-L	£117.60
1634817	Posture Flex Tether Kit, For Posture Flex, MAC	£48.00
1632796	Quad Release Tab for Removal of PostureFlex	£14.70

**Harness interface**

1632758	E2 Chest Harness Interface For E2 Backs 16-20" Wide	£70.70
---------	---	--------

**Bodypoint Parts (Pricing as per Bodypoint Form)**

HW100-150-2	Shoulder harness strap guide (pair) 150mm long		
HW100-200-2	Shoulder harness strap guide (pair) 200mm long		

**Privacy flap attachment to fit all backs from 30.5cm to 50.5cm wide**

1551799	Extra Small	26cm x 41cm	£34.30
1551800	Small	33cm x 41cm	£34.30

**Spare Parts**

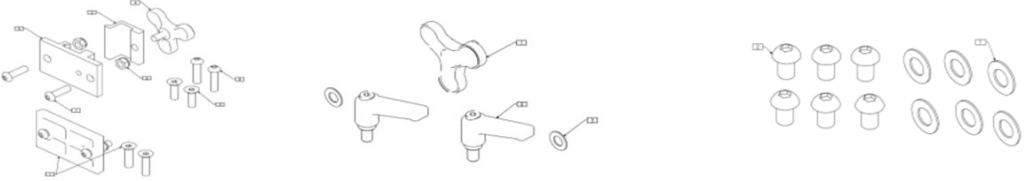

1629821	Spare clamp kit		£60.90
1629819	Spare knob kit		£23.80
1629820	Spare screw kit		£2.80

**Please refer to Matrx Spare Parts price form for other options and accessories**

**TOTAL PRICE:** \_\_\_\_\_

**Special Instructions - Please supply the following information:**

**Name:** \_\_\_\_\_ **Email:** \_\_\_\_\_ **Phone:** \_\_\_\_\_

**Description of special request (please include relevant option code):**